

# POWER POINT SOCKET ASSY RR REPLACEMENT

670L4-01

HINT:

COMPONENTS: See page 67-2

1. REMOVE TONNEAU COVER RETRACTOR SUB-ASSY(See page 76-42 )
2. REMOVE BACK DOOR WEATHERSTRIP(See page 76-42 )
3. REMOVE DECK BOARD SUB-ASSY(See page 76-42 )
4. REMOVE DECK BOARD ASSY(See page 76-42 )
5. REMOVE REAR FLOOR MAT SUPPORT PLATE REAR(See page 76-42 )
6. REMOVE DECK FLOOR BOX RH(See page 76-42 )
7. REMOVE DECK TRIM COVER REAR(See page 76-42 )
8. REMOVE DECK TRIM SIDE BOARD UPR RH(See page 76-42 )
9. REMOVE SIDE TRIM BOX ASSY RH(See page 76-42 )
10. REMOVE REAR DOOR SCUFF PLATE RH(See page 76-42 )
11. REMOVE REAR DOOR OPENING TRIM WEATHERSTRIP RH(See page 76-42 )
12. REMOVE DECK TRIM SIDE PANEL ASSY RH(See page 76-42 )

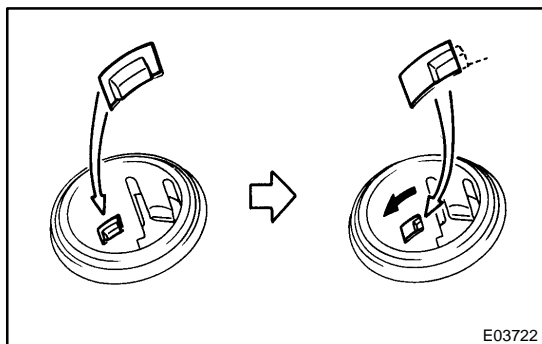

## 13. REMOVE POWER POINT SOCKET ASSY RR

- (a) Turn the socket in the circumference direction as shown in the illustration, disengage the claw between the socket and the power point socket cover RR, and push out the socket to the room side.

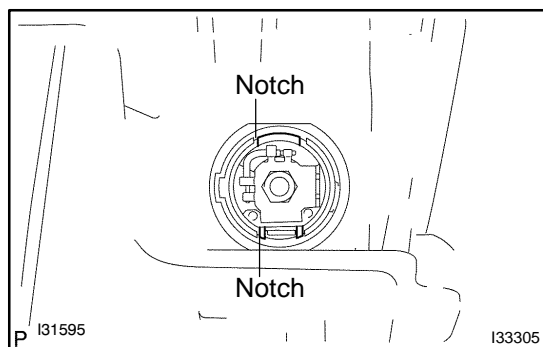

- (b) Align the socket with the notch on the power point socket cover RR, remove the power point socket assy RR to the room side.

## 14. INSTALL POWER POINT SOCKET ASSY RR

- (a) Align the socket with the notch on the power point socket cover RR, push the power point socket assy RR into as hard as possible and install it.